

KSA station

160
200
315

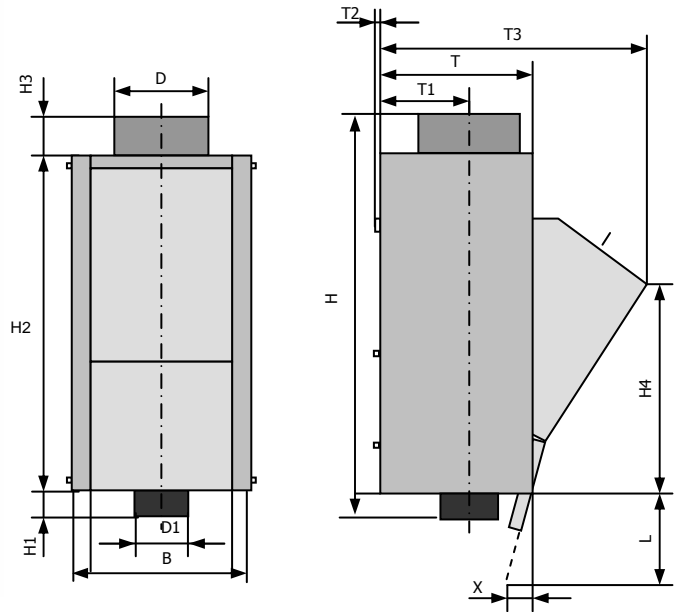

	D	D1	H	H1	H2	H3	H4	T	T1	T2	T3	L	B	X	kg	
OD 160	160	110	696	50	566	80	345	251	141	5	465	135	307	30	17	mm
OD 200	200	160	846	80	666	100	445	291	162	5	507	157	330	25	24	mm
OD 315	315	160	1025	80	845	100	507	542	331	5	795	284	461	30	45	mm

Use:

Only used as an end-station. Arrival **only** from above. **Available in OD 160, 200 and 315mm !** The station is opened and closed automatically !

Dispatch:

The carrier is **not** removed from the station for loading and unloading. The carrier is transported automatically to it's destination. Just push start-button to dispatch.

Receipt:

Carriers arrive gently on a cushion of air. The lid of the carrier can be easily opened manually. The carrier is **not** removed from the station for loading and unloading.

Easy of use

- Ergonomically optimal use through a storage facility in the front area (Open/close automatically)
- For user-security, the integrated start button can only be operated if the station is open.
- The carrier always remains in the system as a "pending" carrier.

Technique

- During a sending process, the front cover is automatically closed.
- After carrier arrival the station opens automatically
- Station is suitable for installation in niches, because all parts are easy accessible in front
- A spacious external bypass achieves the silent receive of arriving carriers.

Quality

- Modern station design; front cover ergonomically designed
- Steelplate housing, front self opening, colour RAL 7035
- Proximity switches
- Industrial grade, heavy duty motor

© by Aerocom - Technical alterations reserved.

aerocom

Aerocom GmbH & Co
Communicationsystems
P.O. Box 10 02 13
73514 Schwaebisch Gmuend
Germany

Phone +49.71 71.10 45 0
Fax +49.71 71.10 45.2 99

info@aerocom.de
www.aerocom.de